

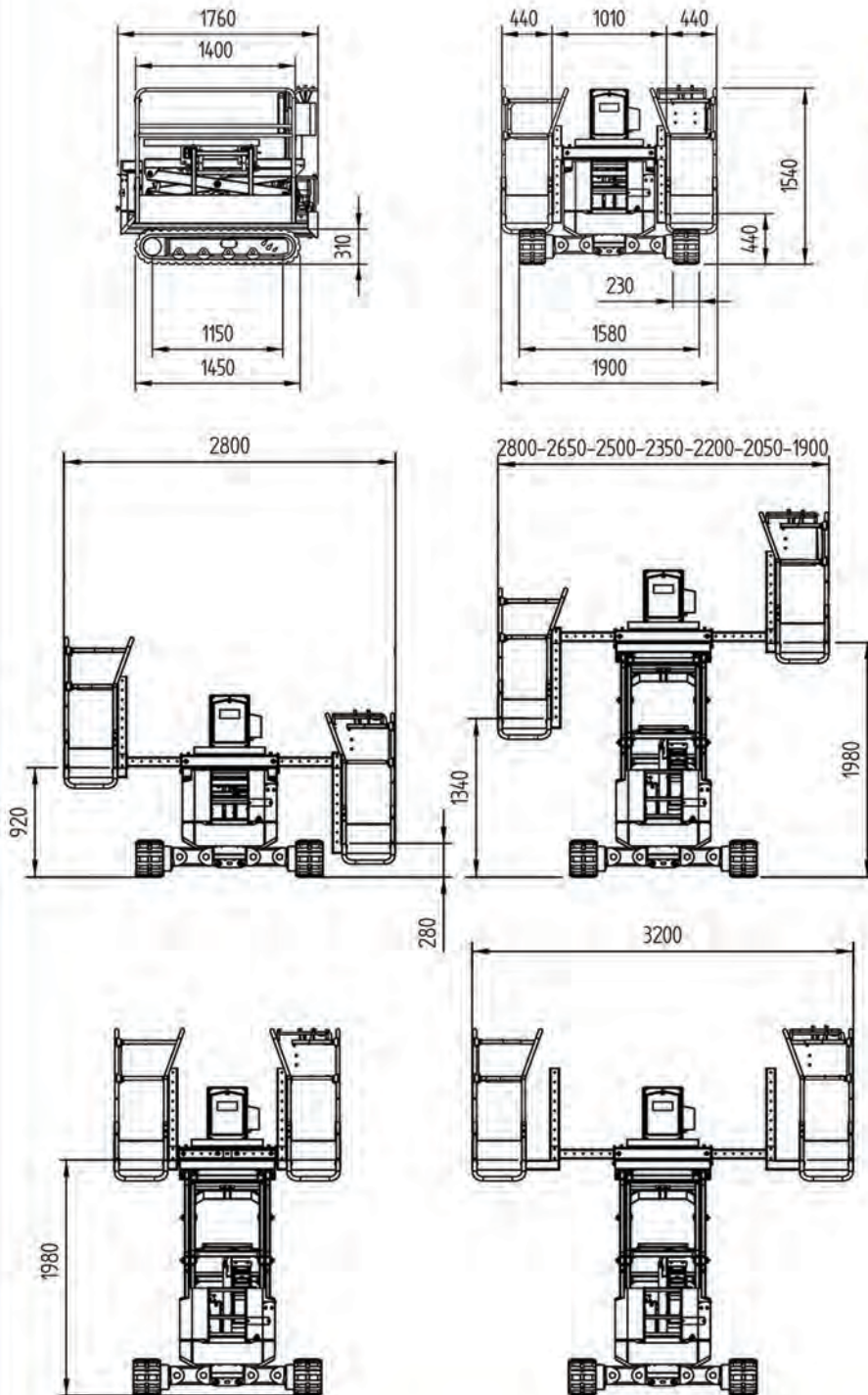

**b** Easy 1.5  
pruning machines







Peso Complessivo (Total Weight) 1300 Kg

### equipaggiamento di serie

 **Max 400Kg (4 persone + 80Kg)**  
**Max 400Kg (4 people + 80Kg)**

 **13HP Honda iGX390 - Benzina**  
**13HP Honda iGX390 - Gasoline**

 **Comandi idraulici a leve**  
**Hydraulic control levers**

 **Contaore digitale**  
**Digital hour meter**

 **Inclinometro elettronico (5°)**  
**Digital inclinometer (5°)**

 **Generatore corrente 220V-1000W**  
**Power generator 220V-1000W**

 **Doppia piattaforma laterale con piano di carico centrale**  
**Double lateral platform with central loading plane**

 **Alimentazione 48V per forbici elettriche da potatura**  
**Power supply 48V for electric shears pruning**

 **Avanzamento automatico con pedale "uomo presente"**  
**Automatic advance with dead man footswitch**

**ALMAC s.r.l.**

Via Caduti Sul Lavoro, 1  
46019 Viadana (Mantova) - ITALY

Phone +39.0375.833.527

info@almac-italia.com www.almac-italia.com